

## Soundsure 300 (SS300), Soundsure 400 (SS400) & Soundsure 560 (SS560)

### INSTALLATION INSTRUCTIONS Acoustic Resilient Layer for Underscreed Applications

**Acoustic cushion underlay designed to reduce the transmission of impact sound through floor screed applications**

Rating: HC/U - Heavy Contract Use, suitable for heavy foot and wheel traffic and castor chairs

Manufactured using Crumb Rubber. Backed by a 10 Year Guarantee

Roll Size: SS300 – 1.00m x 10.00m (10.00 m<sup>2</sup> / roll) / 39.37in x 32.81ft (107.6ft<sup>2</sup> / roll)

SS400 – 1.37m x 11.00m (15.07m<sup>2</sup> / roll) / 54in x 36.09ft (162.2ft<sup>2</sup> / roll)

SS560 – 1.37m x 7.30m (10.0m<sup>2</sup> / roll) / 4ft 49in x 23ft 95in (107.6ft<sup>2</sup> / roll)

1. Pre-Installation ensure that:
  - a. All floor planks are fully grouted without any gaps.
  - b. The concrete floor is swept clean and free of loose material, oil and grease.
2. Before commencing with the installation, take time to familiarise yourself with the products and installation instructions. To complete the installation, you will need the following items:
  - SS300, SS400 or SS560 Roll (acoustic resilient layer)
  - Waterproof Membrane
  - Jointing Tape
  - Tape Measure
  - Sharp Utility / Stanley Knife
  - Straight Edge
3. Lay the acoustic resilient layer (SS300, SS400 & SS560) with the black polypropylene backing surface facing upwards. Cover the entire floor area, overlapping the side and end joints by a minimum of 50mm. Seal the overlapping joints with jointing tape to alleviate the risk of screed leakage (see Image 1).

**Image 1**

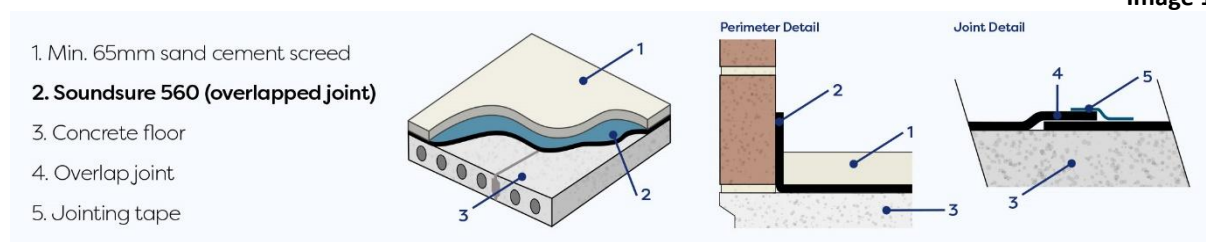

4. The acoustic resilient layer must be laid so that it is lapped up each wall edge and extends to a minimum of 50mm over and above the height of the floor screed. This will ensure that the screed is fully isolated from the walls and floor and that there are no points of contact between the screed and the structure.

Product Code: SS300, SS400 & SS560	Version: 02	Version Date: February 01, 2025	Page 1 of 3
------------------------------------	-------------	---------------------------------	-------------

Interfloor Limited

Tel: +44 (0)1706 213131

Email: [sonixx@interfloor.co.uk](mailto:sonixx@interfloor.co.uk)

Web: [www.interfloor.com/sonixx](http://www.interfloor.com/sonixx)

## Soundsure 300 (SS300), Soundsure 400 (SS400) & Soundsure 560 (SS560)

### INSTALLATION INSTRUCTIONS Acoustic Resilient Layer for Underscreed Applications

**Acoustic cushion underlay designed to reduce the transmission of impact sound through floor screed applications**

Rating: HC/U - Heavy Contract Use, suitable for heavy foot and wheel traffic and castor chairs

Manufactured using Crumb Rubber. Backed by a 10 Year Guarantee

Roll Size: SS300 – 1.00m x 10.00m (10.00 m<sup>2</sup> / roll) / 39.37in x 32.81ft (107.6ft<sup>2</sup> / roll)

SS400 – 1.37m x 11.00m (15.07m<sup>2</sup> / roll) / 54in x 36.09ft (162.2ft<sup>2</sup> / roll)

SS560 – 1.37m x 7.30m (10.0m<sup>2</sup> / roll) / 4ft 49in x 23ft 95in (107.6ft<sup>2</sup> / roll)

5. Where proprietary screeds (minimum thickness 40mm, 80kg/m<sup>2</sup> mass per unit area) are installed, the acoustic resilient layer must be tightly butted together (and not overlapped) and the joints sealed with jointing tape (see Image 2). It is imperative that there are no gaps in the acoustic resilient layer. In these installations, it is recommended that the acoustic resilient layer is covered with a waterproof membrane (minimum 500 gauge), which is overlapped by a minimum of 100mm and sealed at the edges with jointing tape. The membrane must also return up the perimeter walls above the level of the finished floor screed.

**Image 2**

1. Proprietary Screed (Min. 40mm, 80kg/m<sup>2</sup>)
2. Waterproof membrane (Min. 500 gauge polythene)  
– overlap to be a minimum of 100mm and sealed at edges with jointing tape

**3. Soundsure 560 (butted joint)**

4. Concrete floor
5. Butt joint
6. Jointing tape

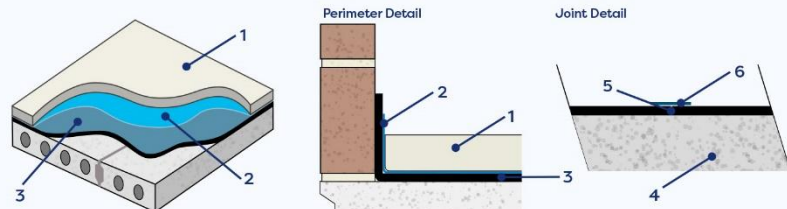

6. All soil pipes and services that go through the acoustic resilient layer must also be isolated from the floor screed. These should be wrapped using the acoustic resilient layer and taped up at all joins.
7. To eradicate the risk of flanking noise transmission, it is essential that the acoustic resilient layer is installed beneath all door frames and at thresholds between apartments and communal areas or stairwells.
8. Following the acoustic resilient layer installation and the isolation of all walls, services and thresholds, the screed can be installed in accordance with the screed manufacturer's instructions.

## Soundsure 300 (SS300), Soundsure 400 (SS400) & Soundsure 560 (SS560)

### INSTALLATION INSTRUCTIONS Acoustic Resilient Layer for Underscreed Applications

**Acoustic cushion underlay designed to reduce the transmission of impact sound through floor screed applications**

Rating: HC/U - Heavy Contract Use, suitable for heavy foot and wheel traffic and castor chairs

Manufactured using Crumb Rubber. Backed by a 10 Year Guarantee

Roll Size: SS300 – 1.00m x 10.00m (10.00 m<sup>2</sup> / roll) / 39.37in x 32.81ft (107.6ft<sup>2</sup> / roll)

SS400 – 1.37m x 11.00m (15.07m<sup>2</sup> / roll) / 54in x 36.09ft (162.2ft<sup>2</sup> / roll)

SS560 – 1.37m x 7.30m (10.0m<sup>2</sup> / roll) / 4ft 49in x 23ft 95in (107.6ft<sup>2</sup> / roll)

9. At the wall edges, the top of the acoustic resilient layer can be folded down over the screed, so that the dry lining can take place. It is essential to ensure that all wall linings and skirting boards are isolated from the screed to avoid flanking sound transmission.
10. Once the wall linings and skirting are installed, any excess acoustic resilient layer can be trimmed back neatly against the skirting board. This then completes the installation and allows for the finished floor to be laid.

Soundsure 560 as an  
Underscreed Resilient Layer

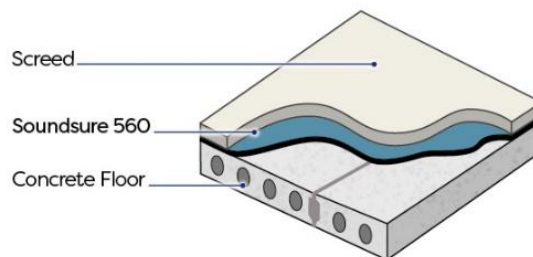

#### UNDERFLOOR HEATING

11. It is possible for underfloor heating systems to be installed within the floor screed. It is essential to prevent fixings of any sort, or clips holding the underfloor heating system, from piercing the acoustic resilient layer or creating any direct points of contact between the floor screed and the structural floor. If the underfloor heating system is being installed over an insulation layer, to which the heating pipes are fixed, the insulation can be laid directly on top of the resilient layer.

Product Code: SS300, SS400 & SS560	Version: 02	Version Date: February 01, 2025	Page 3 of 3
------------------------------------	-------------	---------------------------------	-------------

Interfloor Limited

Tel: +44 (0)1706 213131

Email: [sonixx@interfloor.co.uk](mailto:sonixx@interfloor.co.uk)

Web: [www.interfloor.com/sonixx](http://www.interfloor.com/sonixx)